



presents...

The 2004 UVM Race Weekend

April 17th and 18th in Burlington, Vermont.

USA Cycling Permit Pending

Weekend Schedule:

Saturday April 17th

8am - 10am:

South Greenbush Team Time Trial – Charlotte Vt.

12pm - 2:40pm:

Registration for Road Race and Criterium

1pm - 5pm:

Mt. Philo Road Race – Charlotte Vt.

Sunday April 18th

7:30am - 12pm:

UVM Campus Criterium – Burlington, VT

12:30pm - 1pm:

Awards – UVM Library

UVM Cycling Sponsors:



Mount Philo Road Race - Saturday April 17th:

Course: The Road Race will be raced on a 10.2 mile course, in Charlotte, Vermont. This course is a 'Vermont rolling course' in the Champlain Valley, with spectacular views of the Green Mountains and Lake Champlain. The course encompasses Mt. Philo State Park, and the infamous Mt. Philo access road. The start of the race will take place at the Charlotte Central School, however on the last lap of the race, the riders will make a right hand turn and head up Mt. Philo access road for a hilltop finish. Yellow Line rule will be strictly enforced throughout the race, violators will be subject to DQ. There will be a neutral rollout from the school to the course.

Directions: To Start: From Burlington, take Rt. 7 South approx. 10 miles (through Shelburne) to Hinesburg Road. At the traffic light at Rt. 7 and Hinesburg Road turn left. Proceed on Hinesburg road approx. 1-mile, on your right will be the Charlotte Central School. At the school will be parking, bathroom facilities, and the staging area for the Road Race. The finish of the race will be at Mt. Philo State park, approx. 2 miles away.

From TTT: Go back North on South Greenbush road to stop sign. Turn right. Go straight at light across Rt. 7 onto Hinesburg road. Go approximately 1 mile and on your right will be Charlotte Central School. The TTT course is only 3.5 miles of back roads to the start of the RR and people can easily ride to the start of the RR.

To Finish: From the Charlotte Central School, proceed on Hinesburg Road until the intersection at Mt. Philo Road. (blinking red light). Make a right on Mt. Philo road and proceed 1.5 miles south to the entrance of Mt. Philo State Park. Parking is available at the bottom of the access road only. No cars will be allowed to drive up the access road.

Start Time:	Category:	Laps / Distance:
12:00pm	Registration Opens	
1:00pm	Men's C	4 / 40.8
1:05pm	Men's D	3 / 30.6
1:10pm	Women's B	3 / 30.6
3:00pm	Men's A	6 / 61.2
3:05pm	Men's B	5 / 51.0
3:10pm	Women's A	5 / 51.0

Course Map and Profile:

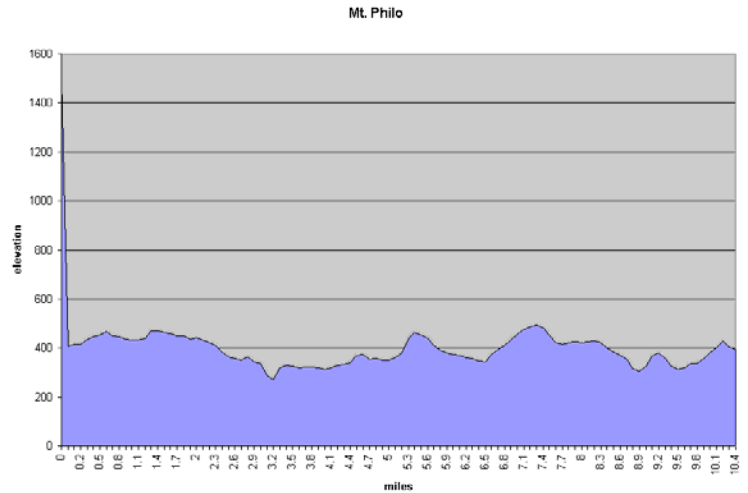
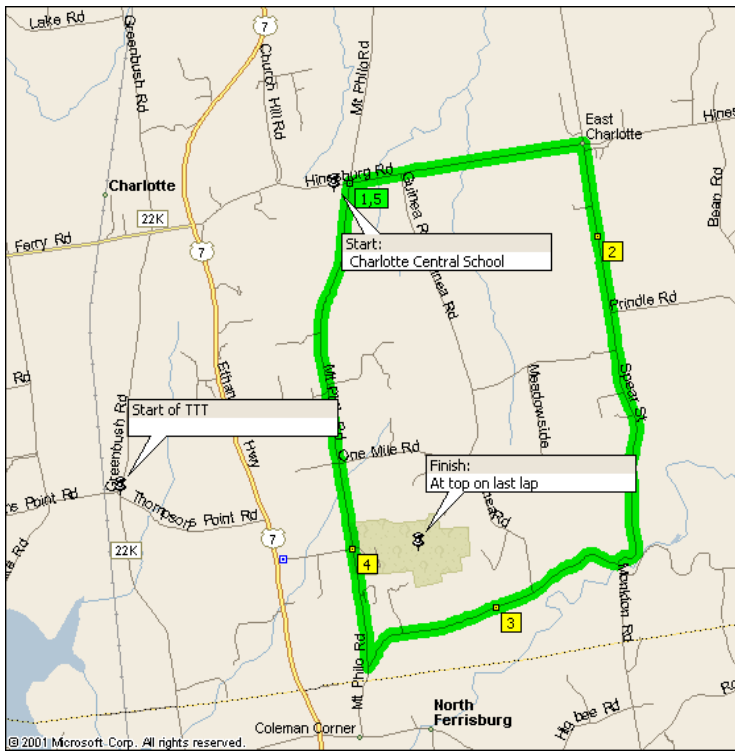

UVM Campus Criterium - Sunday April 18th:

Course: A 1 mile on campus Criterium course on wide roads with good pavement. There is a small hill and 4 corners. It races through the center of campus going by the library, the medical building, and onto Main Street. Promises to be fast and action packed with lots of spectators.

Directions: From Downtown: Take Main Street east up the hill away from the lake. Within a mile you will come to campus and be at the race course and be directed to parking.

From I-89: Get off at the Rt.2 exit and head west towards downtown Burlington. Within a mile you will come to the UVM campus and the race course and be directed to parking.

Start Time:	Category:	Time + Laps:
7:00am	Men's D	20 minutes + 2 laps
7:30am	Women's B	25 minutes + 2 laps
8:00am	Men's C	30 minutes + 2 laps
8:45am	Men's B	45 minutes + 2 laps
9:45am	Women's A	45 minutes + 2 laps
10:45am	Men's A	60 minutes + 2 laps

Course Map:

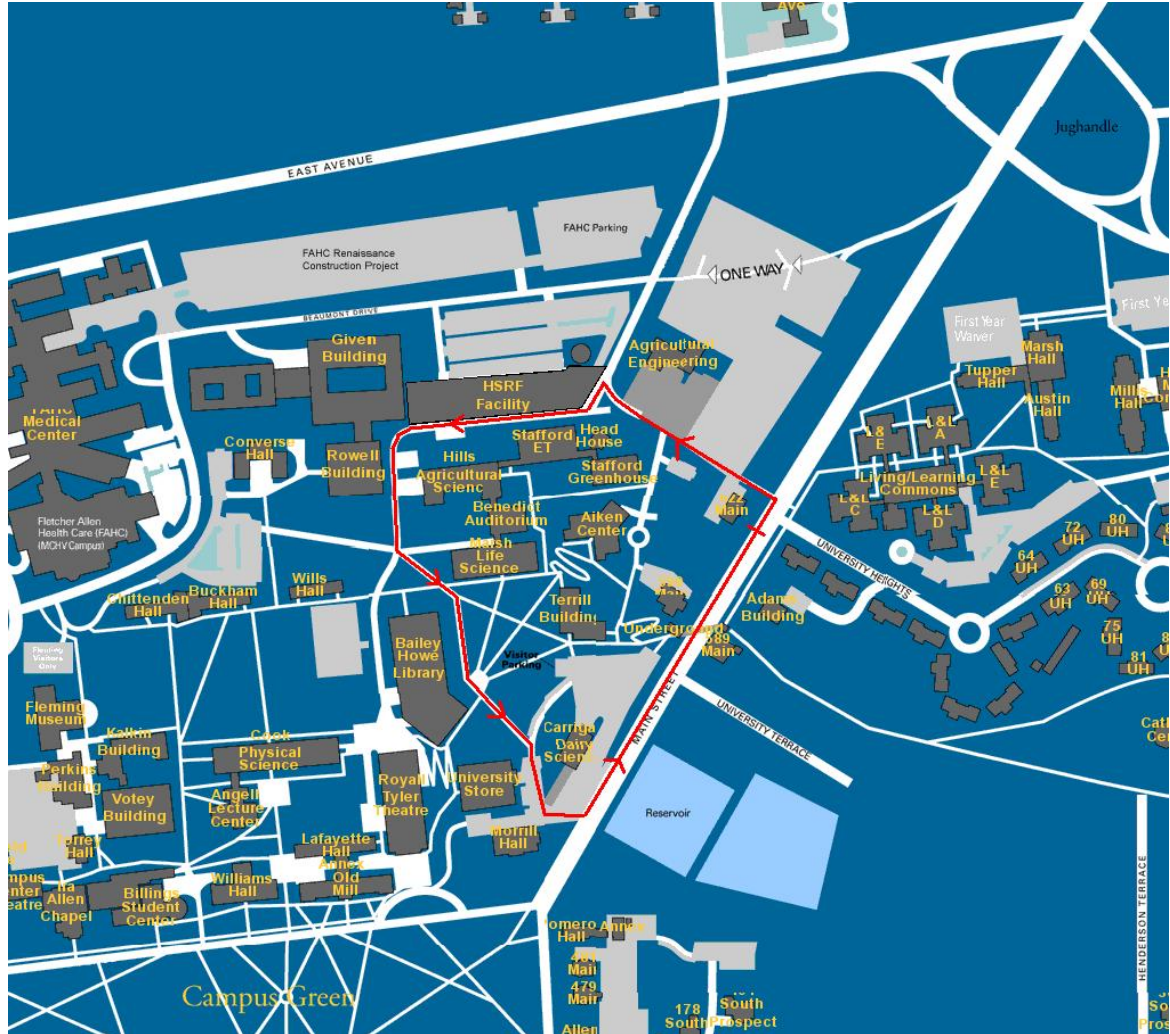

Awards – Sunday April 18th:

After the last criterium we will have awards as soon as results are finalized. We will have medals for the top 3 for each race and have team trophies for the top 3 teams for the weekend. The award ceremony will take place at the library on the back side of the course.

Registration:

Registration will be available online, e-mailed lists, mail-in and at the Road Race.

Online: Registration online at Bikereg.com up until Thursday April 15th 2004 at 5pm.

E-mail: An excel spread sheet with rider name, category, license number and PEP number must be sent before Thursday April 15th 2004 at 5pm. All riders put on list must be paid for. No exceptions. E-mail to: Cycling@uvm.edu.

Mail: Entries that are postmarked before Friday April 8th, 2004 will be accepted as pre-registration. They must include a rider list, signed 2004 USA Cycling release forms (as needed), and payment must be mailed to:

UVM Cycling
B156 Billings Student Center
Burlington Vermont 05405
Phone: (802) -865-4614
Fax: (802) - 656 -7719

Race Day: Registration is available the day of the road race only for both the Criterium and the Road Race. Registration will take place at the Start of the Road Race at the Charlotte Central School. There will be no race day registration for the Criterium or the Team Time Trial. Race day registration is subject to a \$5 late fee per race. Registration for the Road Race closes 30 minutes before each race.

Fees and Payment:

It is \$13 per racer per race for the Road Race and the Criterium and \$20 per team for the Team Time Trial. Please make all checks payable to "UVM Cycling." All pre-registered riders must be paid for.

Contact info:

For all race questions contact Kevin Bouchard-Hall at krboucha@uvm.edu or (802) 865-4614.

UVM Cycling Sponsors:



Directions:

To Burlington Vermont:

Please visit this website for directions to Burlington Vermont.

<http://www.vermont.org/directions/index.html>



Hotel Information:

Comfort Inn

1285 Williston Road
South Burlington Vermont 05403
Burlington, VT 05403
United States
(802)865-3400

Burlington Super 8 Motel & Suites

1016 Shelburne Road (Route 7)
Burlington, VT 05403
802-862-6421

University Inn - Burlington

1 Dorset Street (Exit 14E off interstate 89)
Burlington, VT United States
1-800-808-4656 or (802) 863-5541

Holiday Inn Burlington

1068 Williston Road
Burlington, VT 05403
1-802-863-6363

[Other Hotels can be found by Checking out these sites:](#)

<http://www.innvermont.com>

<http://www.vermont.org/overview/index.html>